



SchoolMessenger[®]

Creating an App Store Connect API Key

Introduction

The following guide will walk you through the process of creating an App Store Connect API key for your application. You will need to provide this key to the Custom App team so that they can automatically deploy updates to your application.

How to create App Store Connect API key

Log in to <https://appstoreconnect.apple.com/>.

Click your application.

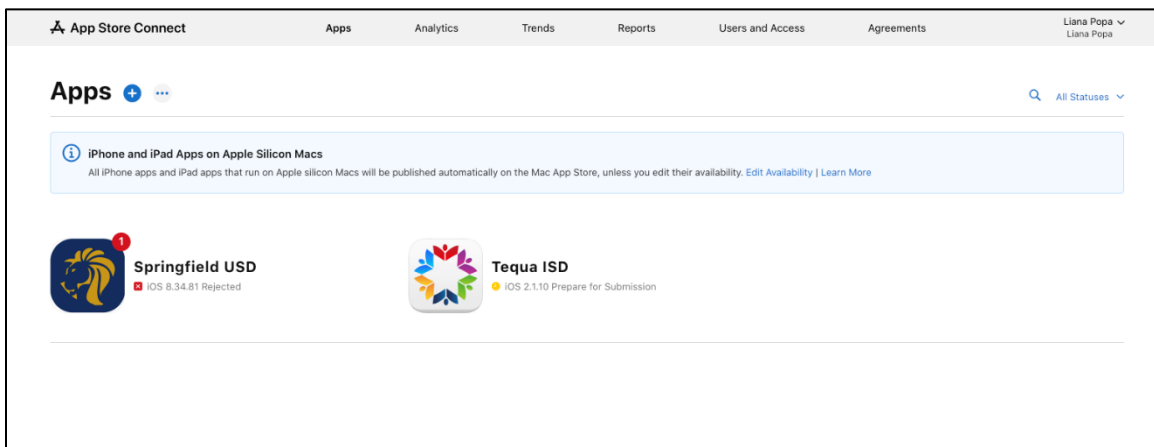

Click the **User and Access** tab and select the **Keys** tab.

Click the **App Store Connect API** tab.

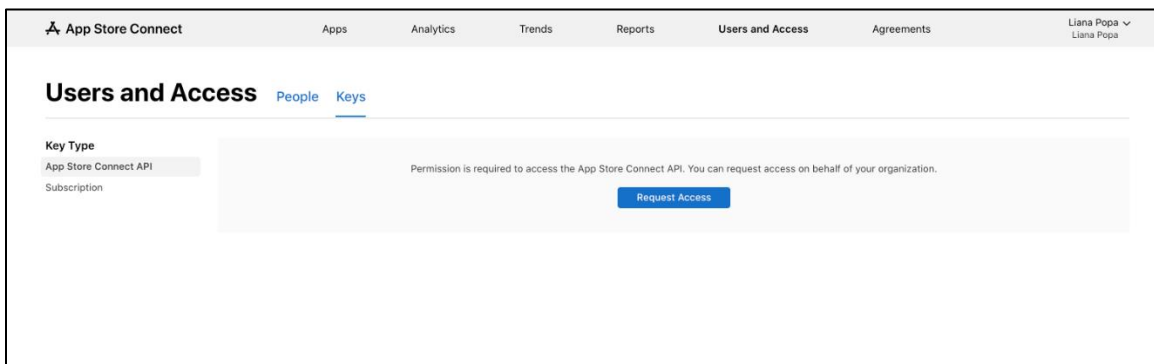

Click **Generate API Key** or the **+** button.

Input the **Name** and set the access to **App Manager**.

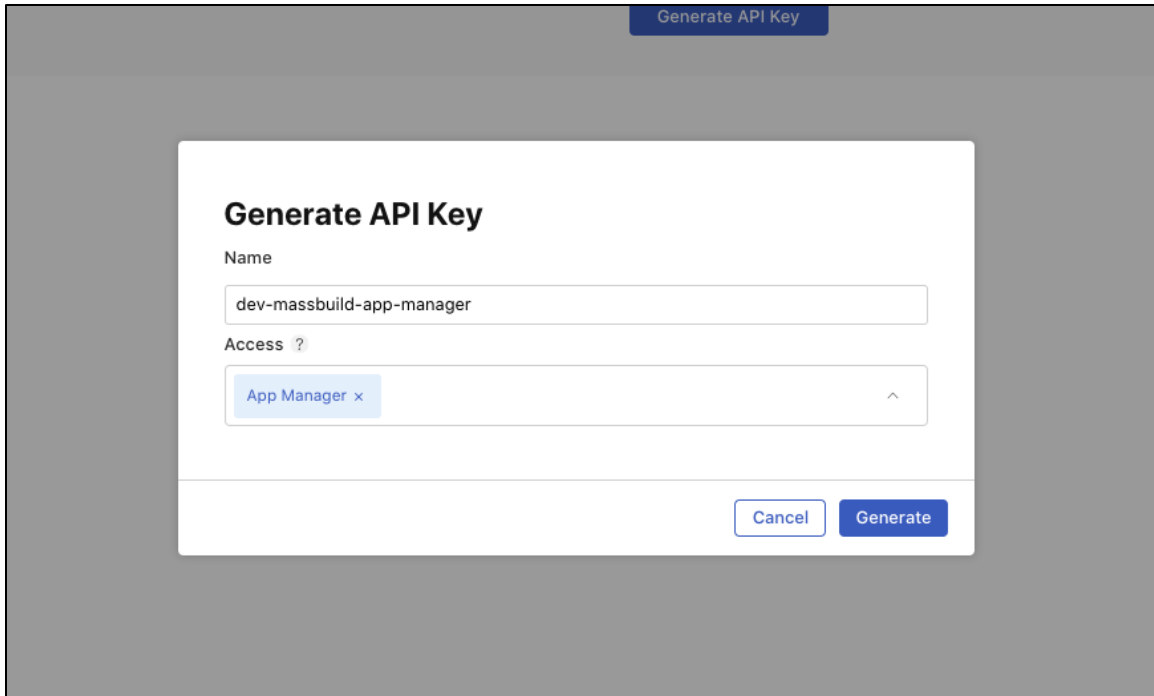

Click **Generate**.

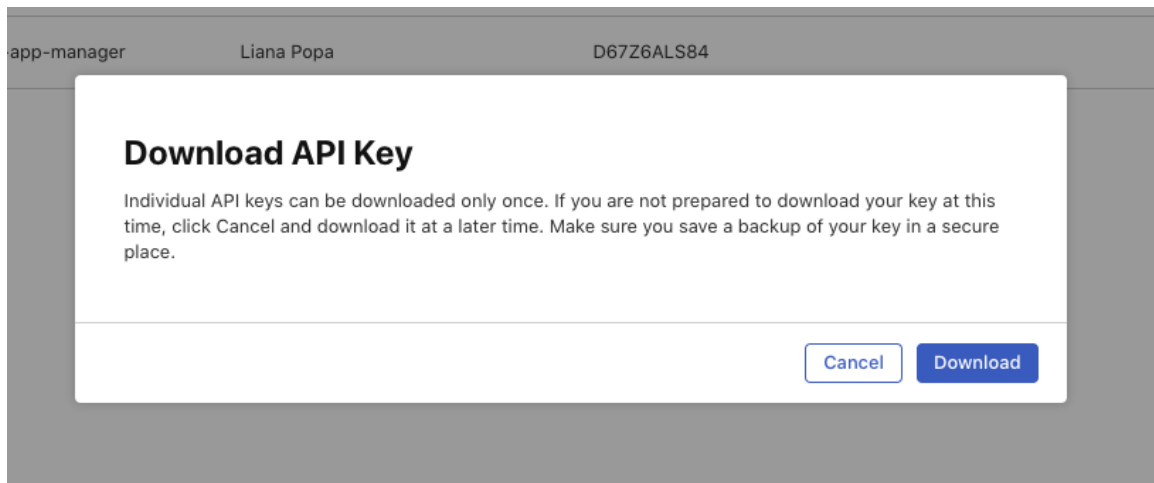

Click **Download** to save the API key.

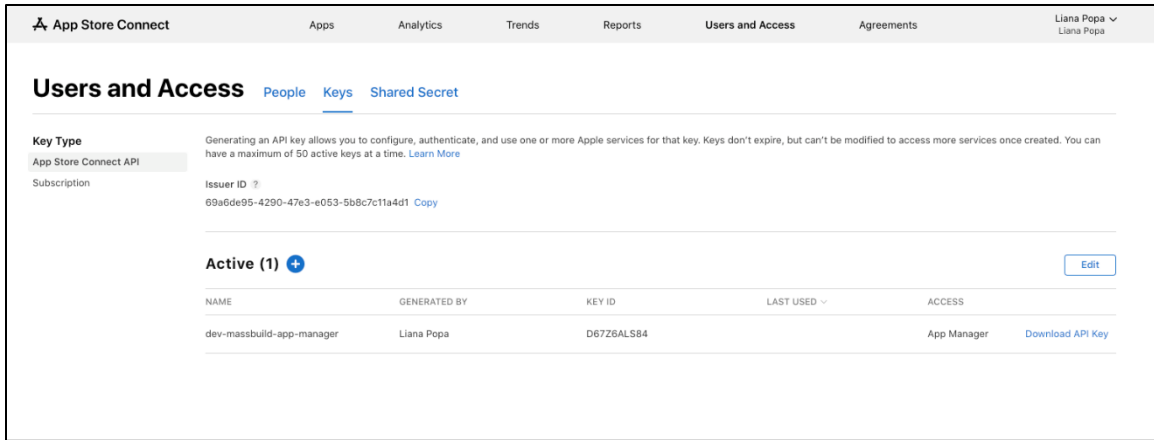

The screenshot shows the 'App Store Connect' interface. The top navigation bar includes 'App Store Connect', 'Apps', 'Analytics', 'Trends', 'Reports', 'Users and Access', and 'Agreements'. The user 'Liana Popa' is logged in. The 'Users and Access' section is active, with sub-tabs for 'People', 'Keys', and 'Shared Secret'. Under 'Key Type', 'App Store Connect API' is selected. A 'Subscription' key is shown with an 'Issuer ID' of '69a6de95-4290-47e3-e053-5b8c7c11a4d1' and a 'KEY ID' of 'D67Z6ALS84'. Below this, a table lists active keys:

NAME	GENERATED BY	KEY ID	LAST USED	ACCESS
dev-massbuild-app-manager	Liana Popa	D67Z6ALS84		App Manager Download API Key

Copy the **Issuer ID** and the **KEY ID** for your new key.

Please send an email to appdev@schoolmessenger.com with the full name of your district in the email subject line. In the email, include the **Issuer ID**, the **KEY ID** and the API file you created for your application.